

NOTES: UNLESS OTHERWISE SPECIFIED

1. MANUFACTURED AND INSPECTED IAW AS9100 QUALITY SYSTEM REQUIREMENTS.
2. ABBREVIATION USED IN TITLE IS: VALVE REGULATED SEALED LEAD ACID (VRSLA).
3. SEE DRAWING NO. CB-00272 AND PROCEDURE P-1000 FOR ASSEMBLY AND TEST INSTRUCTION. PROCEDURES AND ASSEMBLY DRAWINGS ARE FOR INTERNAL USE ONLY.
4. BATTERIES ARE RATED IAW INTERNATIONAL ELECTROTECHNICAL COMMISSION STANDARD 60952-1 AND RTCA DO-293, UNLESS OTHERWISE NOTED.

REVISIONS			
REV	DESCRIPTION	DATE	APPROVED
A	REV HEIGHT AND ADDED TABS	9/21/99	JBT
B	2X .10 WAS 2X .20	7/18/09	JBT
C	UPDATED NOTES 1, 2, 5, AND RATINGS PER TSO TEST	11/6/09	JBT
D	ADDED CG WITH DIMS, DELETED NOTES 1 & 6, RENUM NOTES 2 THRU 5	4/8/10	JBT

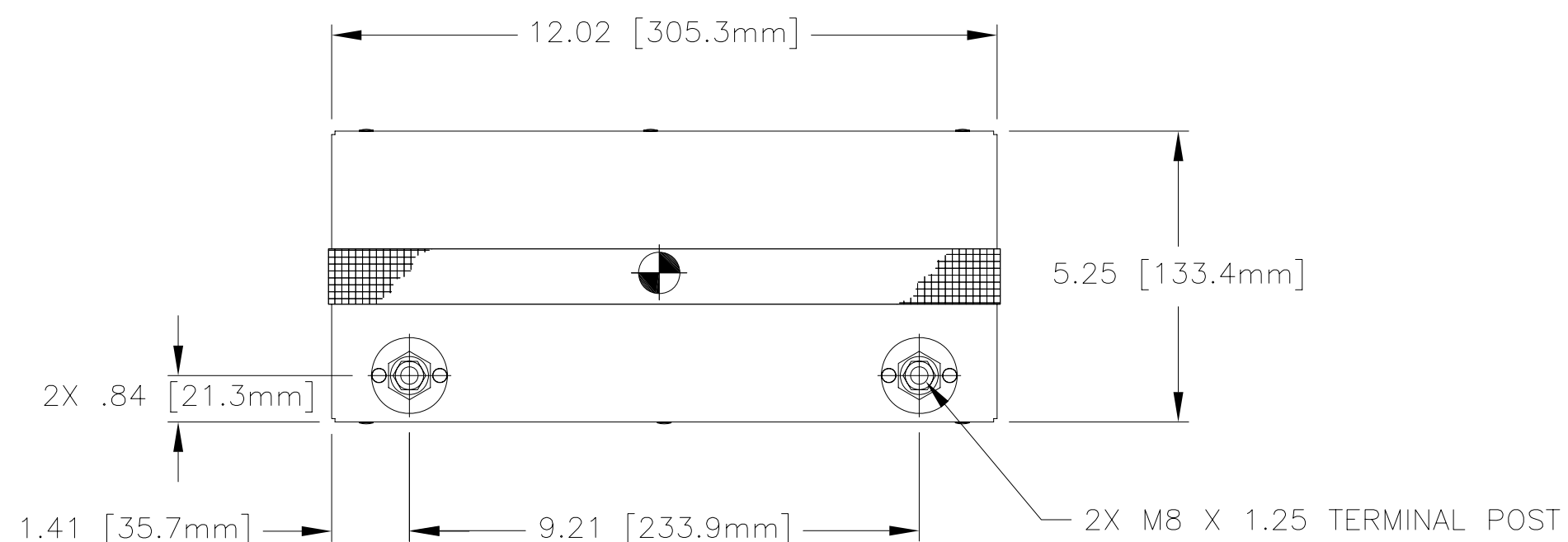

PART NUMBER	RG-350
MAXIMUM WEIGHT	41 LBS [18.6 KG]
RATED CAPACITY, C ₁	17 AH
POWER RATING AT 23°C	Ipp 900 A, Ipr 625 A
POWER RATING AT -18°C	Ipp 600 A, Ipr 425 A
POWER RATING AT -30°C	Ipp 450 A, Ipr 300 A

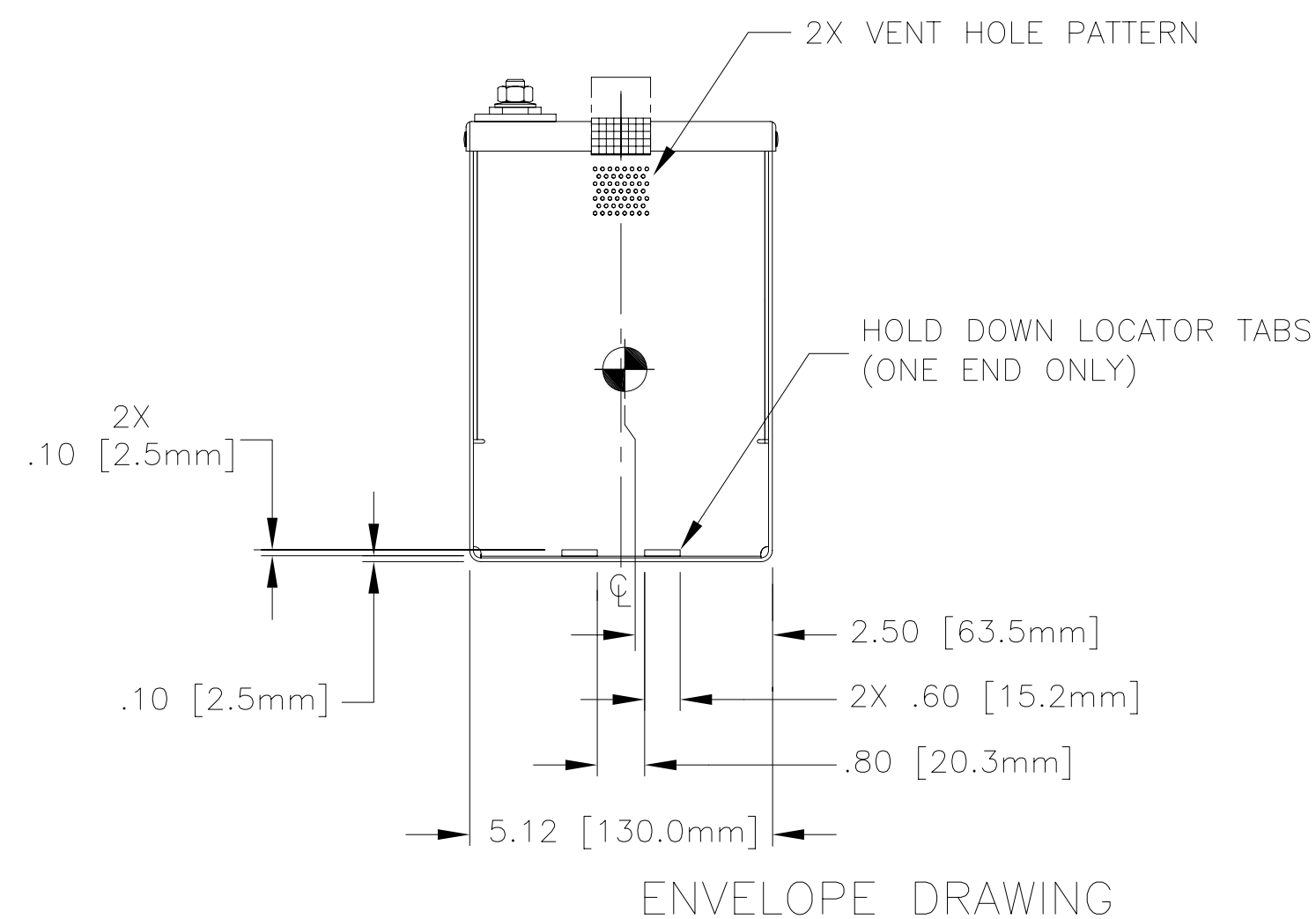
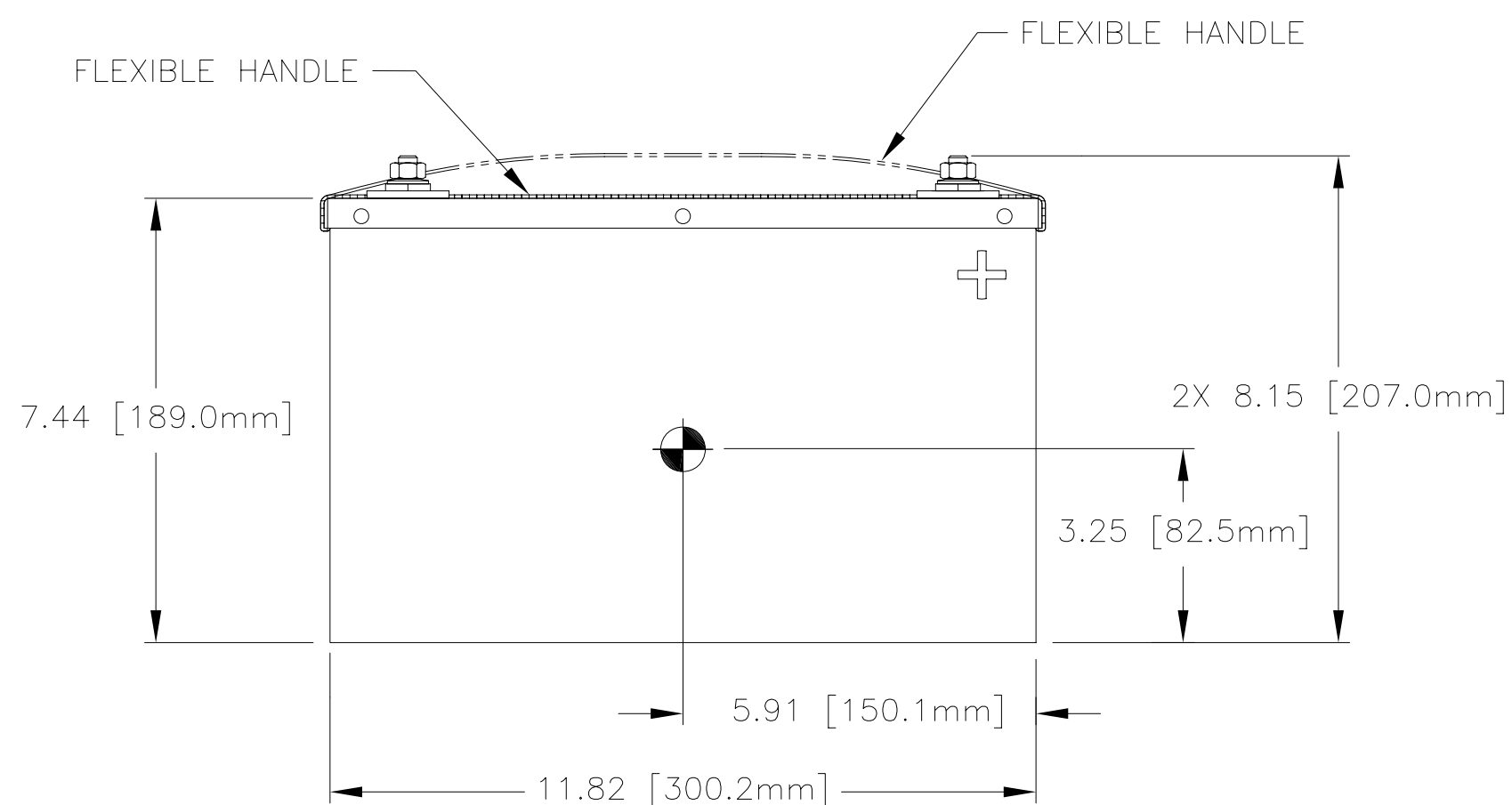

ENVELOPE DRAWING

QTY REQD	CAGE CODE	PART OR IDENTIFYING NO.	NOMENCLATURE OR DESCRIPTION	MATERIAL SPECIFICATION	ITEM NO.	
PARTS LIST						
UNLESS OTHERWISE SPECIFIED DIMENSIONS ARE IN INCHES TOLERANCES ARE:			CONTRACT NO.			
FRACTIONS DECIMALS ANGLES			CONCORDE BATTERY CORPORATION			
± 1/32 .XX ± .06 ± 1°			2009 SAN BERNARDINO RD, W. COVINA, CA 91790			
.XXX ± .030			TITLE			
			BATTERY, VRSLA, 24 VOLT			
TREATMENT	NONE	CHECKED	AMIII	2/9/99	SIZE	
FINISH	NONE	APPROVED	JBT	2/9/99	CAGE CODE	
SIMILAR TO	ACT WT	CALC WT	ISSUED	JJ	4/12/10	DWG. NO.
						RG-350
						REV
						D
						SCALE
						1=3
						SHEET
						1 OF 1