

NOTES: UNLESS OTHERWISE SPECIFIED

- BATTERY CONFORMS TO THE DESIGN REQUIREMENTS OF 14 CFR PART 25.1353(c).
- INSPECT PER FAR 21.303(h) QUALITY SYSTEM.
- ABBREVIATION USED IN TITLE IS: VALVE REGULATED SEALED LEAD ACID (VRSLA).
- SEE DRAWING NO. CB-00321 AND PROCEDURE P-1000 FOR ASSEMBLY AND TEST INSTRUCTION. PROCEDURES AND ASSEMBLY DRAWINGS ARE FOR INTERNAL USE ONLY.
- BATTERIES ARE RATED IAW INTERNATIONAL ELECTROTECHNICAL COMMISSION STANDARD 952-1, UNLESS OTHERWISE NOTED.
- DIMENSIONS ARE IN INCHES AND MILLIMETERS SHOWN IN BRACKETS [MM].

REVISIONS			
REV	DESCRIPTION	DATE	APPROVED

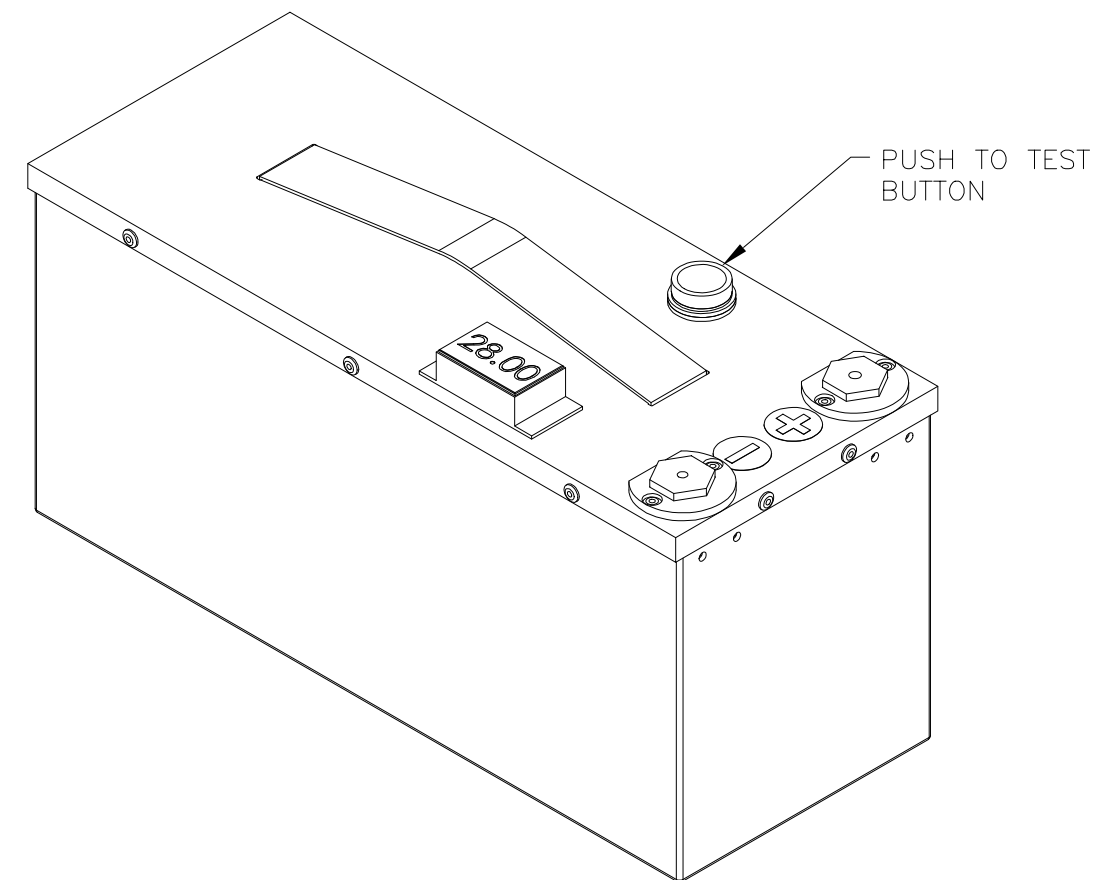
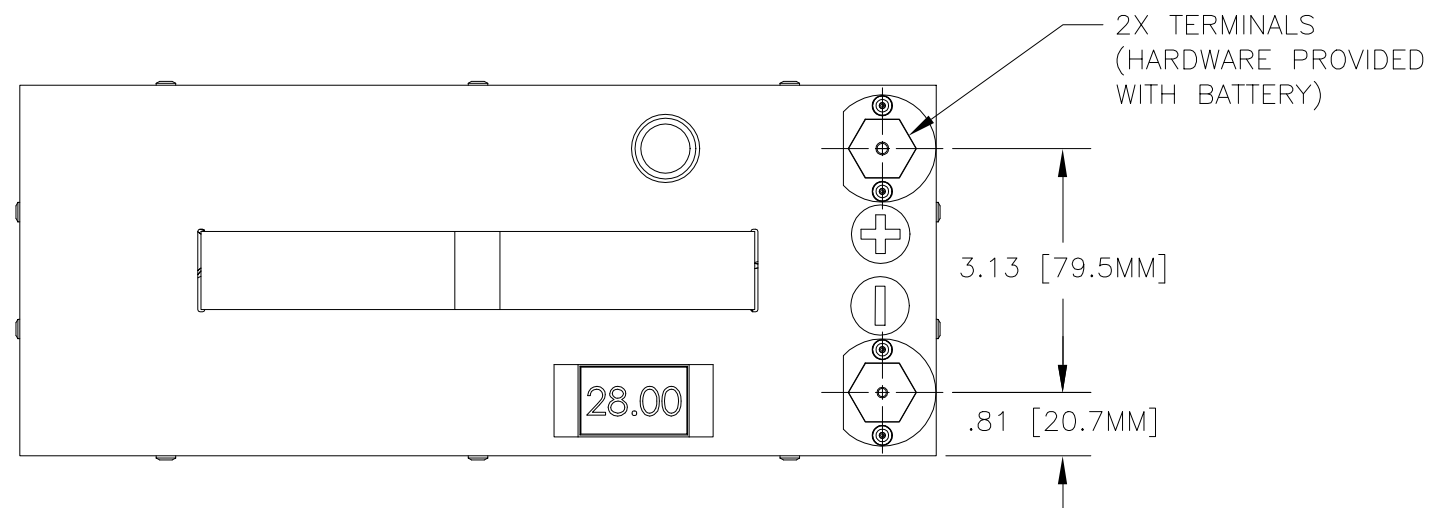

REFERENCE VIEW

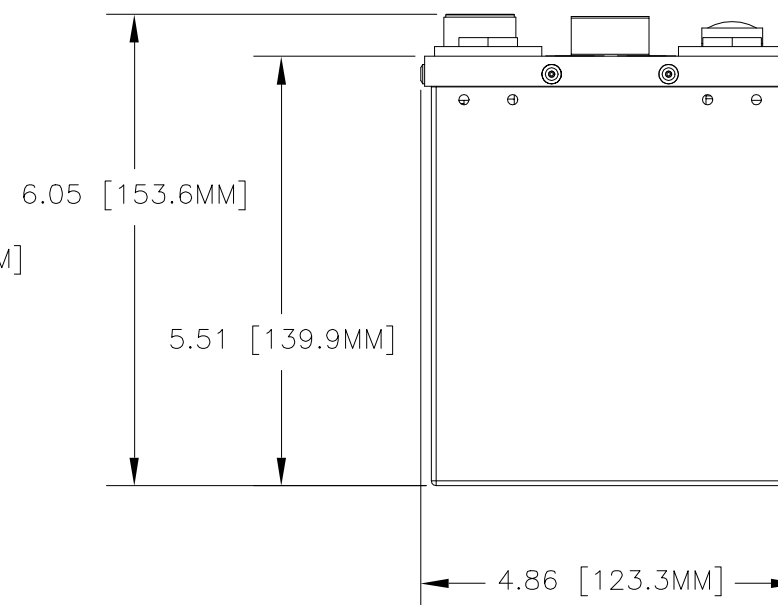
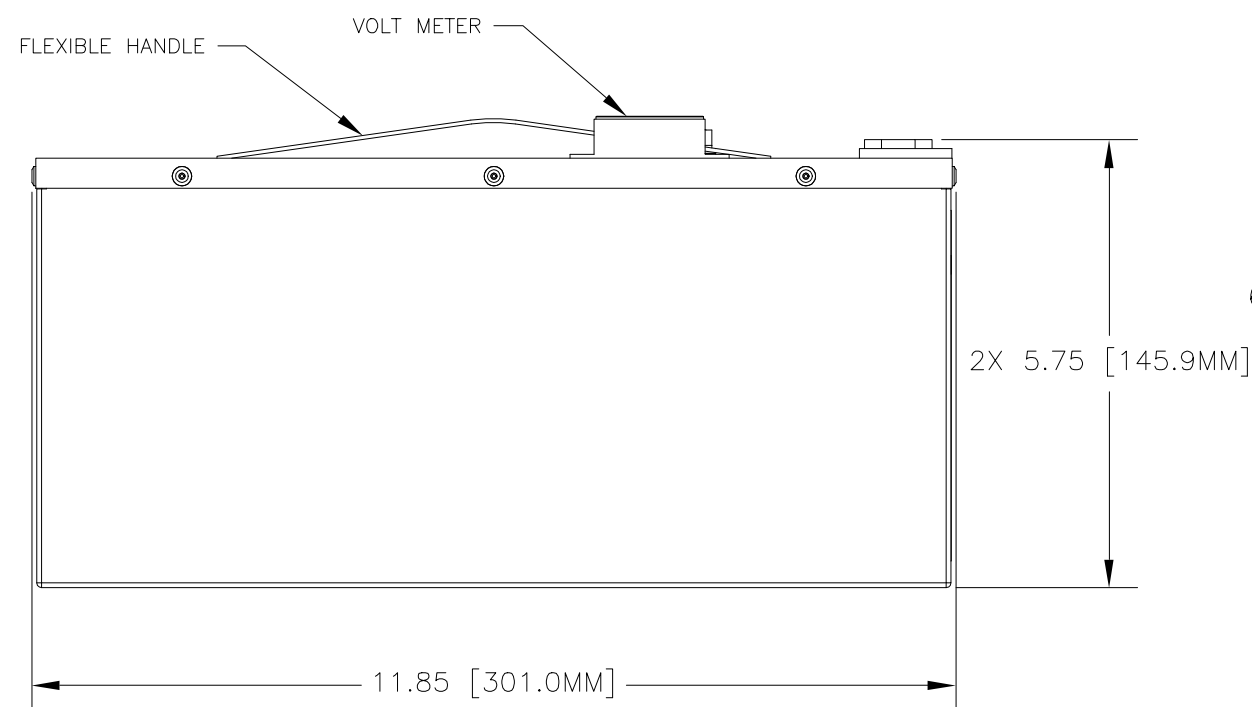

ENVELOPE DRAWING

PART NUMBER	RG-28-7		
MAXIMUM WEIGHT	30 LBS [13.6 KG]		
RATED CAPACITY, C ₁	9.0 AH		
POWER RATING	NOT RATED		
TEST TEMPERATURE	@23°C (74°F)	@-18°C (0°F)	@-30°C (-22°F)
CAPACITY, 9.0 A	9.0 AH	6.6 AH	4.3 AH
RAPID DISCHARGE, 54 A	6.7 AH	NOT RATED	2.4 AH

QTY REQD	CAGE CODE	PART OR IDENTIFYING NO.	NOMENCLATURE OR DESCRIPTION	MATERIAL SPECIFICATION	ITEM NO.
PARTS LIST					
UNLESS OTHERWISE SPECIFIED DIMENSIONS ARE IN INCHES TOLERANCES ARE:			CONCORDE BATTERY CORPORATION		
FRACTIONS	DECIMALS	ANGLES	2009 SAN BERNARDINO RD, W. COVINA, CA 91790		
± 1/32	.XX ± .06	± 1°	TITLE		
	.XXX ± .030		BATTERY, VRSLA, 28 VOLT		
TREATMENT	NONE	CONTRACT NO.	CAGE CODE 63017		
FINISH	NONE	NA	DWG NO. RG-28-7		
SIMILAR TO NA	ACT WT NA	CALC WT NA	APPROVALS	DATE	REV
			DRAWN ELH	9/24/01	
			CHECKED HRF	9/24/01	
			APPROVED JBT	9/26/01	
			ISSUED AT	10/2/01	
SCALE NONE			SHEET 1 OF 1		